

## IEC Plug I, Cord Connector (Rewireable), Angled

**Description**

Screwing cable terminal, Pin temperature 70 °C, Protection class I, Screw clamps  
 - Note: strain relief has to be ordered separately, mating strain reliefs please find under accessories

**Approvals**

- VDE Certificate Number: 40008629  
 - CSA File Number: 1435558

**References**

We recommend for new applications the type [4789](#)  
 Last order possibility: 31.05.2011

**Weblinks**

[pdf](#), [html](#), [General Product Information](#), [Approvals](#), [RoHS](#), [CHINA-RoHS](#), [Mating Connectors](#), [e-Shop](#), [SCHURTER-Stock-Check](#), [Distributor-Stock-Check](#), [Accessories](#), [Detailed request for product](#)

**Technical Data**

Ratings IEC	16A / 250VAC; 50Hz	Plug	I acc. to IEC/EN 60320-1 UL 498, CSA C22.2 no. 42 (for cold conditions) pin-temperature 70 °C, 16A, Protection Class 1
Ratings UL/CSA	21A / 250VAC; 60Hz		
Dielectric Strength	> 4 kVAC between L-N > 2 kVAC between L/N-PE (1 min/50Hz)		
Allowable Operation Temp.	-25 °C to 70 °C		
Degree of Protection	from front side IP 40 acc. to IEC 60529		
Protection Class	Suitable for appliances with protection class 1 acc. to IEC 61140		
Terminal	Screw clamps		
Material: Housing	PA6, black / grey / white, UL 94V-0		

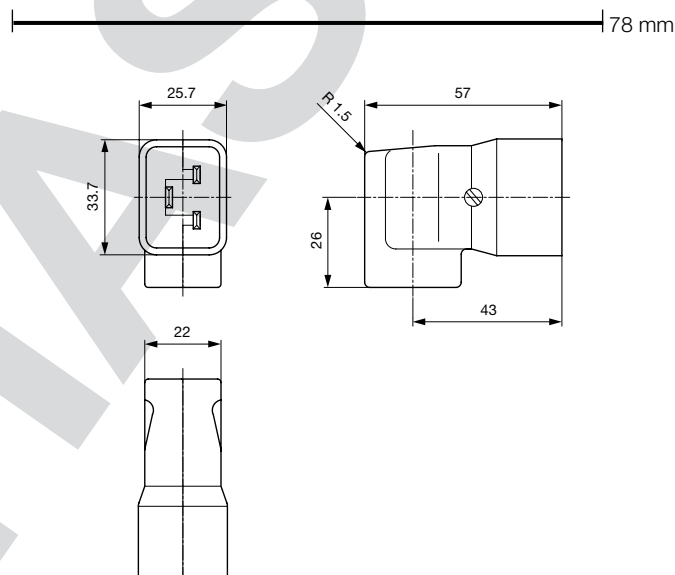
**Dimensions**

## Config. Code

1611 - H - A B C 0 - D - E J

The characters are placeholders for the correspondingly keys of selections from the key tables.

1611 - H - A B C 0 - D - E J = Type

Type	Configuration key
protection class 1	X

1611 - H - A B C 0 - D - E J = Terminals

Terminal L	Configuration key
screw terminal	A

1611 - H - A B C 0 - D - E J = Terminals

Terminal N	Configuration key
screw terminal	A

Symbols similar as in table A

1611 - H - A B C 0 - D - E J = Terminals

Terminal Ground	Configuration key
screw terminal	A

Symbols similar as in table A

1611 - H - A B C 0 - D - E J = Color

Color	Configuration key
Black	A
Grey	B
White	D

1611 - H - A B C 0 - D - E J = Style

Style	Configuration key
for cord assembly	8

1611 - H - A B C 0 - D - E J = Condition

Condition	Configuration key
assembled	1
disassembled	2

**Packaging unit** 50 Pcs

## Accessories

### Description



[4311.0053](#)  
PVC Strain Relief for cable outside diameter 8.7mm, 3 x 16AWG



[4311.0068](#)  
PVC Strain Relief for cable outside diameter 10mm, 3 x 14AWG



[4311.9305](#)  
PVC Strain Relief for cable outside diameter 8.7mm-10mm, 3 x 14AWG

## Description



4311.9306  
PVC Strain Relief for cable outside diameter 8.7mm-10mm, 3 x 14AWG



4311.9316  
PVC Strain Relief for cable outside diameter 8.7mm, 3 x 16AWG



4311.9317  
PVC Strain Relief for cable outside diameter 8.7mm, 3 x 16AWG



4311.9318  
PVC Strain Relief for cable outside diameter 10mm, 3 x 14AWG



4311.9319  
PVC Strain Relief for cable outside diameter 10mm, 3 x 14AWG

## Mating Outlets/Connectors

## Category / Description

[Appliance Outlet Overview complete](#)



IEC Appliance Outlet J, Screw-on Mounting, Front Side, Solder or Quick-connect Terminal	0723
IEC Appliance Outlet J, Snap-in Mounting, Front Side, IDC Terminal	4710
IEC Appliance Outlet J, Snap-in/Screw-on Mounting, Front Side, Solder or Quick-connect Terminal	4797
IEC Appliance Outlet J, Snap-in Mounting, Front Side, Quick-connect Terminal	5013
IEC Appliance Outlet J, Screw-on Mounting, Front Side, Quick-connect Terminal	5016

[Appliance Outlet further types to1611](#)

...

## Connector Overview complete



IEC Connector C19, Rewireable, Straight	0104
IEC Connector C19, Rewireable, Straight	0104U
IEC Connector C19, Rewireable, Angled	1651
IEC Connector C19, Rewireable, Straight	1652
IEC Connector C19, Rewireable, Angled	4790

Connector further types to1611

...

## Power Supply Cord Overview complete



US Power Supply Cord with IEC Connector C13, hospital grade	4300.0920
US Power Supply Cord with IEC Connector C19, straight	6009.5195

Power Supply Cord further types to1611

## Power Supply or Interconnection Cord Overview complete

Diverse Power Supply and Interconnection Cords 16 A	6003.0395
---	-----------

Power Supply or Interconnection Cord further types to1611



## Rewireable Connector for Cable, straight entry Overview complete

IEC Connector C19, Rewireable, Straight	0921
---	------

Rewireable Connector for Cable, straight entry further types to1611

PHASE